



Installation

Model specific instructions

For:

- **BMW K1600GT**
- **BMW K1600GTL**
- **BMW K1600 Bagger**

These instructions are a model specific add-on to the general BoosterPlug installation instructions.

The general BoosterPlug installation instructions can be found in the "Downloads" section on the BoosterPlug.com website:

<http://www.boosterplug.com/shop/cms-downloads.html>

Installation Tips

- Remove the right hand side fairing
- Locate the AIT sensor in the Air filter box between the gas tank and the frame
- The pictures below should help you locate the sensor
- Install the BoosterPlug module as per the general installation papers
- A good spot for the BoosterPlug temperature sensor is next to the airbox snorkel intake hole, or as shown in the pictures below

Pictures

For:

- **BMW K1600GT**
- **BMW K1600GTL**
- **BMW K1600 Bagger**

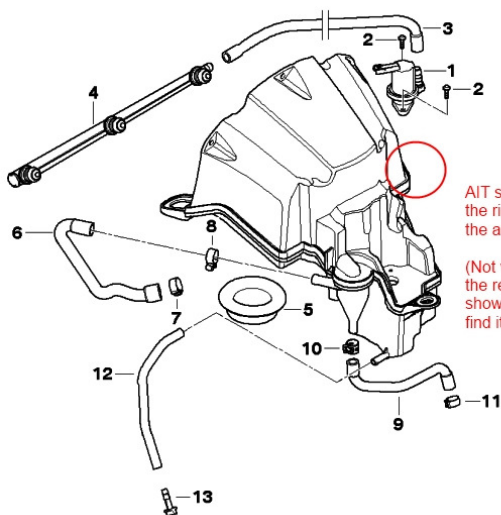

00227642

