



# Installation

Model specific instructions

For:

- [Ducati Hypermotard 796](#)
- [Ducati Hypermotard 821](#)
- [Ducati Hypermotard 939](#)
- [Ducati Hypermotard 1100](#)
- [Ducati Hypermotard 1100 EVO](#)
- [Ducati Hyperstrada 821](#)
- [Ducati Hyperstrada 939](#)
- [Ducati Streetfighter 848](#)
- [Ducati Streetfighter 1098](#)

These instructions are a model specific add-on to the general BoosterPlug installation instructions.

The general BoosterPlug installation instructions can be found in the "Downloads" section on the [BoosterPlug.com](http://www.boosterplug.com) website:

<http://www.boosterplug.com/shop/cms-downloads.html>

## Installation Tips

- The pictures below should help you locate the AIT sensor where the BoosterPlug is installed.
- Install the BoosterPlug module as per the general installation papers.
  - On the Hypermotard, 796, and 1100 EVO series, the AIT sensor is located in the air intake hose between the Air filter box and the throttle valve housing.
  - On the Streetfighter 848 and 1098, the AIT sensor is inside the small head light fairing on the left hand side of the bike.
  - On the Hyper 821/939 bikes, and the Hypermotard 1100, the AIT sensor is behind the head light on the left hand side of the bike.
    - For the Streetfighters, Hyper 821/939, and 1100 Supermotard bikes, the external sensor on the BoosterPlug is already in the right spot, so you just need to secure it with a zip-tie to prevent it from flopping around.

## Pictures

For:

- [Ducati Hypermotard 1100 \(Top Picture\)](#)
- [Ducati Hypermotard 796 - \(Bottom picture\)](#)
- [Ducati Hypermotard 1100 EVO - \(Bottom picture\)](#)

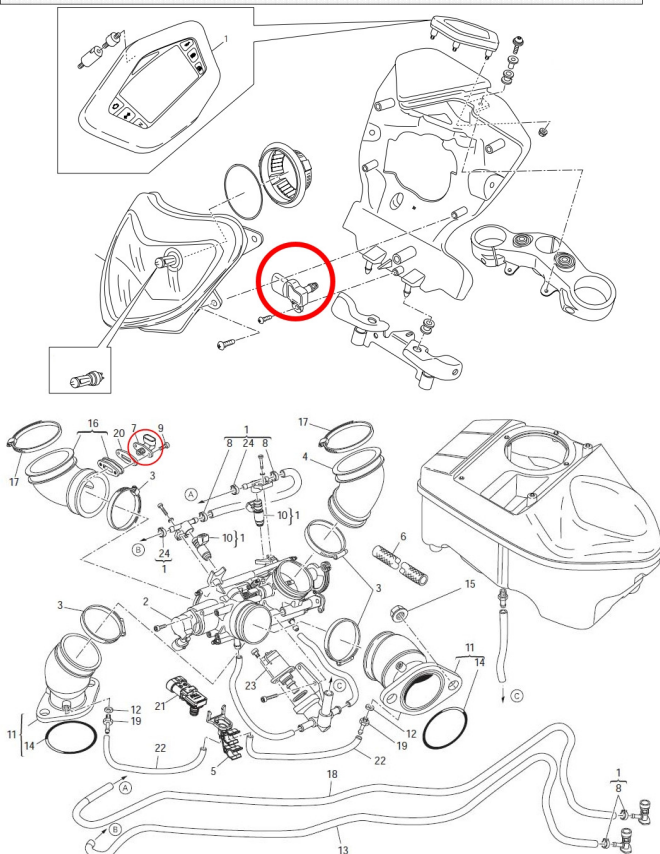

For:

- [Ducati Hypermotard 821 and 939 - \(Top picture\)](#)
- [Ducati Hyperstrada 821 and 939 - \(Top picture\)](#)
- [Ducati Streetfighter 848 \(Bottom picture\)](#)
- [Ducati Streetfighter 1098 \(Bottom picture\)](#)

