



# Installation

Model specific instructions

For:

- **Ducati Panigale 899 (All)**
- **Ducati Panigale 959 (All)**
- **Ducati Panigale 1199 (All)**
- **Ducati Panigale 1299 (All)**
- **Ducati Panigale V2**

These instructions are a model specific add-on to the general BoosterPlug installation instructions.

The general BoosterPlug installation instructions can be found in the "Downloads" section on the BoosterPlug.com website:

<http://www.boosterplug.com/shop/cms-downloads.html>

## Installation Tips

- Install the BoosterPlug module as per the general installation papers.
- The pictures below should help you locate the AIT sensor where the BoosterPlug is installed.
- The AIT sensor is located inside the fairing.
- Route the external sensor to a spot under the heat light and secure it with a zip-tie so it's not flopping around.

## Pictures

For:

- **Ducati Panigale 899 (All versions)**
- **Ducati Panigale 959 (All versions)**
- **Ducati Panigale 1199 (All versions)**
- **Ducati Panigale 1299 (All versions)**

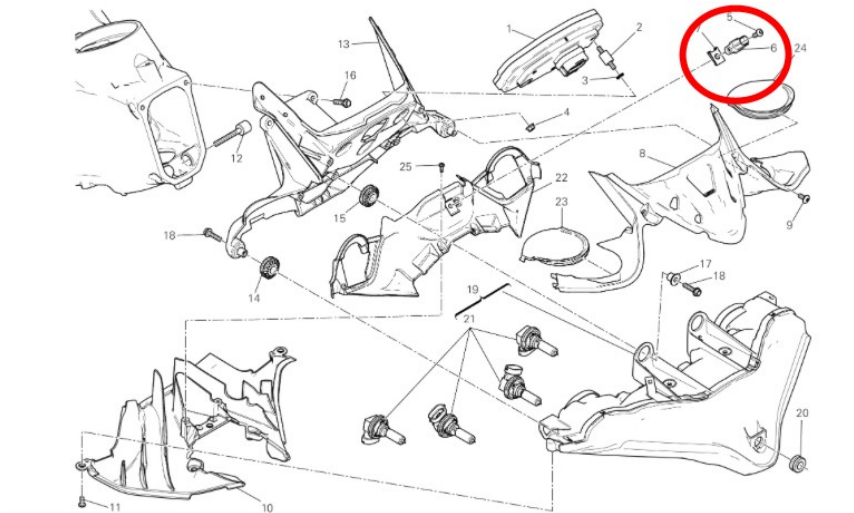
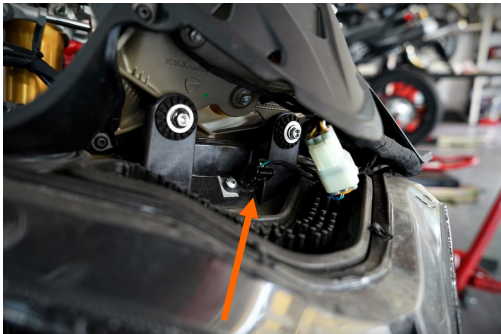

For:

- **Ducati Panigale V2**

