



Installation

Model specific instructions

For:

- KTM 690 Duke (3) (2008-2011)
- KTM 690 Duke R (3) (2009-2011)
- KTM 690 Duke (4) (2012-2016)
- KTM 690 Duke R (4) (2012-2016)
- KTM 690 Duke R (4) (2017-up)
- KTM 690 Supermoto
- KTM 690 Supermoto R

These instructions are a model specific add-on to the general BoosterPlug installation instructions.

The general BoosterPlug installation instructions can be found in the "Downloads" section on the BoosterPlug.com website:

<http://www.boosterplug.com/shop/cms-downloads.html>

Installation Tips

- Install the BoosterPlug module as per the general installation papers.
- The pictures below should help you locate the AIT sensor where the BoosterPlug is installed.
- On the Duke 3 (until 2011) and on the 690 Supermoto, the AIT sensor is located inside the airbox
 - Remove the air filter cartridge to get access to the AIT sensor
 - Don't cut the zip-ties that is used to roll up the sensor cable on the BoosterPlug - just connect the BoosterPlug and leave the unit with the rolled-up sensor inside the air filbox - (There's plenty of space in there).
- On the Duke 4 (From 2012 and up), the AIT sensor is found in the air intake duct between the air filter box and the throttle valve body.

Pictures

For:

- KTM 690 Duke (3) (2008-2011)
- KTM 690 Duke R (3) (2009-2011)
- KTM 690 Supermoto
- KTM 690 Supermoto R

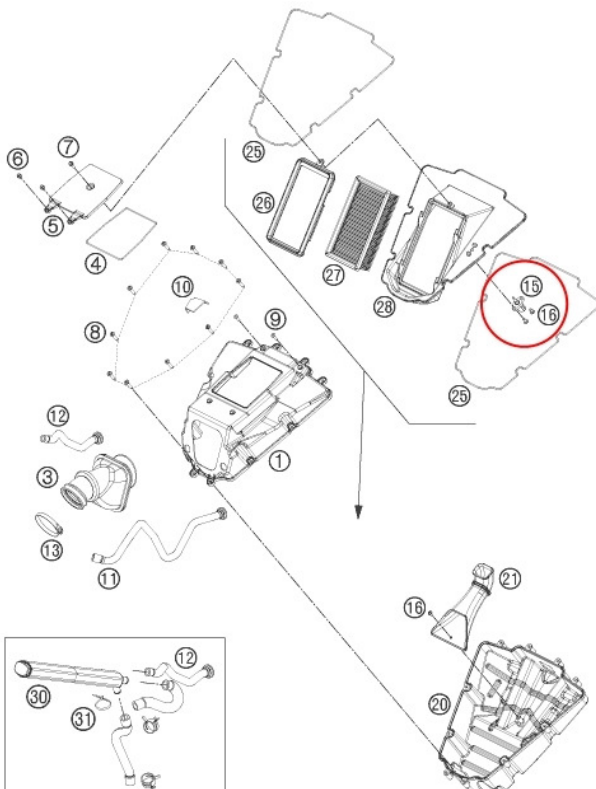

For:

- KTM 690 Duke (4) (2012-2016)
- KTM 690 Duke R (4) (2012-2016)
- KTM 690 Duke R (4) (2017 and newer)

